

CLASS II
citymood 12
ITALIAN TECHNOLOGY LOOKS TO THE FUTURE



#ioquidoitaliano



TECHNICAL SPECIFICATIONS

CITYMOOD 12 LNG CL. II

VEHICLE FEATURES	
Vehicle category and class	Allround ultra-low walking surface, Category M3, Class II
KINEMATIC CHAIN	
Position	Rear-mounted Longitudinal
Vaccine	FPT CURSOR 9 LNG
Emissions level	Euro VI
Number of cylinders	6
Displacement (cc)	8.710
Maximum power (kW)	264
Maximum torque (Nm)	1.640
Transmission	Automatic transmission ZF Ecolife 6 Speed + Reverse, Integrated hydraulic retarder
TREATMENTS	
Minimum turning diameter (wall-to-wall in mm)	20.976
Maximum negotiable gradient (%)	18
Maximum speed (km/h)	95
STRUCTURE	
Framing	High-quality S 355 J0 steel in a lattice of closed rectangular tubes
Anti-corrosion treatment	Full immersion cataphoretic treatment
SUSPENSION	
Suspensions	Pneumatic with electronic control, Kneeling and automatic trim adjustment
Front axle	Independent front wheel type ZF RL 82 EC
Rear axle	ZF AV 133 with dual reduction inverted portal
BRAKING SYSTEM AND DRIVING SYSTEM	
Front and rear brakes	Pneumatic system, disc on all wheels, automatic wear recovery
Steering equipment	BOSCH 8098 power steering, height and inclination adjustable steering wheel with pneumatic control
CAPACITY	
Maximum permissible mass (kg)	18.000
Fuel tank capacity (l)	4 tanks 3 tanks 2 tanks
	1116 liters 837 liters 558 liters
DIMENSIONS	
Vehicle length (mm)	12.100
Vehicle width (mm)	2.550
Height (mm)	3.480
Front overhang (mm)	2.800
Rear overhang (mm)	3.400
Pitch between 1st and 2nd axis (mm)	5.900
Passenger compartment internal height max (mm)	2.346
Door 1 step height (mm)	320
Door 2 step height (mm)	325
Front/rear overhang angle (°)	7 / 7
WHEELS AND TYRES	
Front tire and rim dimensions	275/70 R 22,5 7,5 X 22,5 Single
Rear tire and rim dimensions	275/70 R 22,5 7,5 X 22,5 Double
ELECTRICAL SYSTEM	
Battery (Voltage & Capacity)	2x12V - 220 Ah
Alternators (Current & Voltage)	2x150 Ah - 28V
Electronic system	Multiplex with programmed logic - Integral CAN BUS on-board network
PASSENGER CAPACITY	
Total passenger capacity (ECE R107)*	82

*passenger capacity depends on required configuration

MAIN STANDARD AND OPTIONAL CONFIGURATIONS

EXTERIOR		AIR CONDITIONING	
2 Doors	S	Driver seat heating and adjustable passenger compartment heating by separate electronic control	S
3 Doors	O	Driver seat cooling and adjustable passenger compartment cooling by separate electronic control	S
LED daytime running lights	S	Unit Heaters and Linear Convectors for supplementary heating	O
Front single-leaf ejection door***	O	Programmable preheater integrated into the electrical system	S
Fog lights with cornering function	O		
Electrically adjustable and heated door mirrors	S	DRIVING SEAT	
Side windows with sliding opening (1/3 of height)	S	Fabric seat (automatic pneumatic adjustment)	S
Side windows with flap opening (1/3 of height)	O	Summer seat (automatic pneumatic adjustment)	O
Athermic side crystals in grey	S	Separate driver's cabin	S
More tinted side windows	O	Totally separate driver's cabin	O
Heated driver's window	O	Roller blind to the left of the driver's seat	S
Heated front door leaf	O	Roller blind in front of the driver's seat	S
Pastel colour bodywork	S	Roller blind in front of the driver's seat	O
Bodywork with custom livery	O		
INTERNALS		PASSENGER SECTION	
Non-slip mat with turn-up along the side walls (150 mm)	S	Padded passenger seats	S
Painted rails (colour to be specified)	S	Disabled persons station with folding seats	O
Stainless steel handrails	O	Manually operated central door folding ramp	O
Partition walls for door compartments in tempered glass	S	USB sockets on hand rails	O
Passenger stop request system	S	Roof hatch (manually operated)	S
Internal LED lighting	S	Electrically operated roof hatch with automatic closure	O
Baggage racks***	O		
Seats mounted on raised podiums***	O	SAFETY	
		Electronic Stability Control	S
		Electro-pneumatic brake system (EBS)	S
		Automatic stop brake with movement lock	S
		Anti-lock braking system (ABS)	S
		Anti Slip Regulation system (ASR)	S
		Front and rear stabiliser bar	S
		Fire prevention system	S
		Audible reverse signal	S
		Rear parking sensors	O
		Gas leak detection system	O
		TPMS	O
		S: Standard O: Optional	
ON-BOARD TECHNOLOGICAL SYSTEMS			
Arrangement provision/Installation of LCD or LED route indicators**	O/O		
Arrangement provision/Installation of ticket validation and/or issue machines**	O/O		
Arrangement provision/Installation of passenger counting system **	O/O		
Arrangement provision/Installation of CCTV system (2nd and 3rd door + rear view camera)**	O/O		
Arrangement provision/Installation of video surveillance system**	O/O		
Arrangement provision/Installation of stop announcement sound system**	O/O		
Arrangement provision/Installation of AVM system**	O/O		
Arrangement provision/Installation of user information system**	O/O		
Arrangement provision/Installation of onboard wireless connectivity system (Wi Fi Router)	O/O		
MP3 Player + USB Radio	O		

** adaptable to customer requests

*** available soon

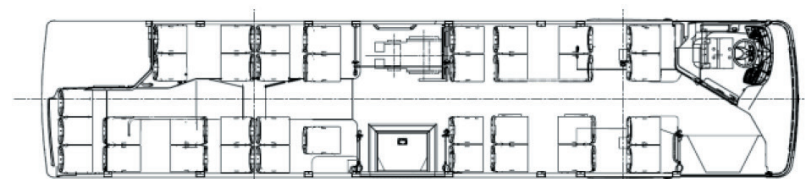

LNG: 36 SEATS - 2 DOORS

